

Installing ATI OKI Sublimation Toner And OKI Front Panel Settings

1. Raise the top cover of your printer.

Reference Figure 1 on the right.

Figure 1

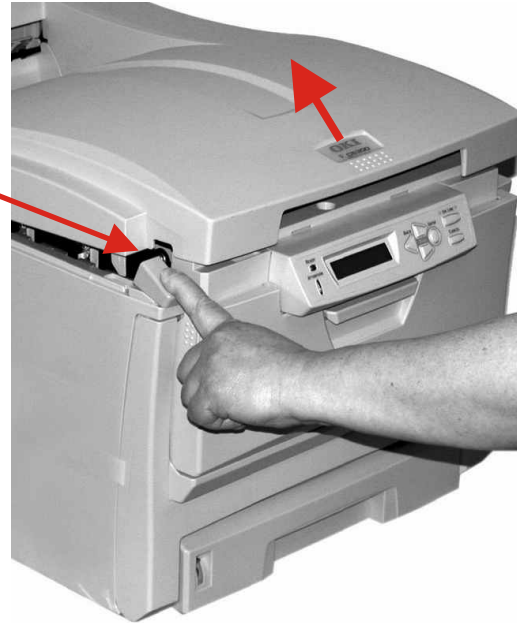

2. Place a trash bag on your work area.

Note: The work area should be in a garage or other area where the toner installation will not cause any problems if any is spilled.

3. Remove the Black (K) cartridge and drum from your printer.

Each cartridge (C,M,Y, or K) has the color letter indication on one side of the cartridge.

Reference Figure 2 on the right.

Figure 2

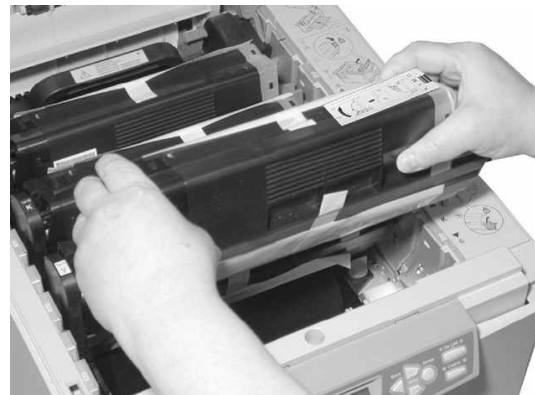

4. After you have removed the cartridge take it to your safe work area as mentioned in step 2.

Turn the cartridge and drum upside down so the green roller with the protective paper is facing up.

Caution: Use care when handling the assembly as not to damage the green roller. Also, exposure to direct sunlight can damage the green roller.

Reference Figure 3 on the right.

Figure 3



Green Roller
Facing Up

Do this over your trash bag!

5. With your other hand that is not holding the cartridge underneath turn the blue knob on the right side to release the cartridge from the drum.

Pull down slightly on the cartridge and upwards on the drum only on the blue knob side to separate.

Reference Figure 4 on the right.

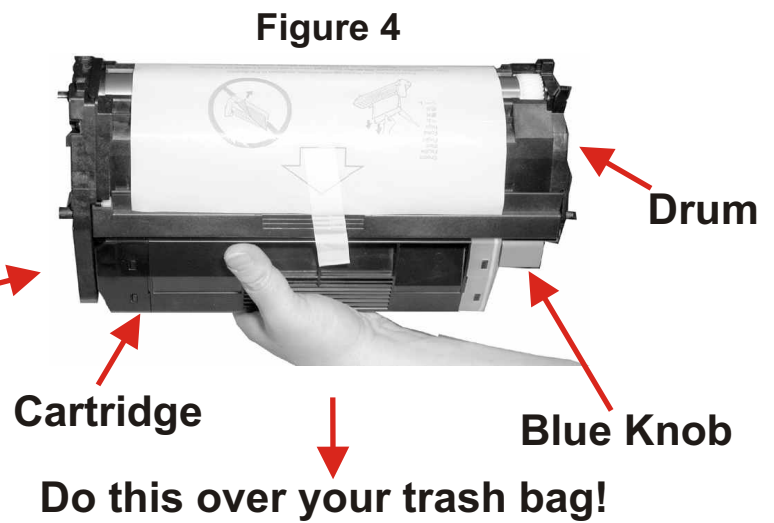

6. Once the cartridge disconnects you must gently wiggle out the cartridge in the direction toward the blue knob as there is a spring on the other side that holds the assembly in place.

Once the assembly is completely apart set the drum section carefully on it's side with the green drum roller not touching anything.

Turn the blue knob back to the original position to keep the toner from escaping.

Stow away your OEM toner cartridge.

Reference Figure 5 on the right.

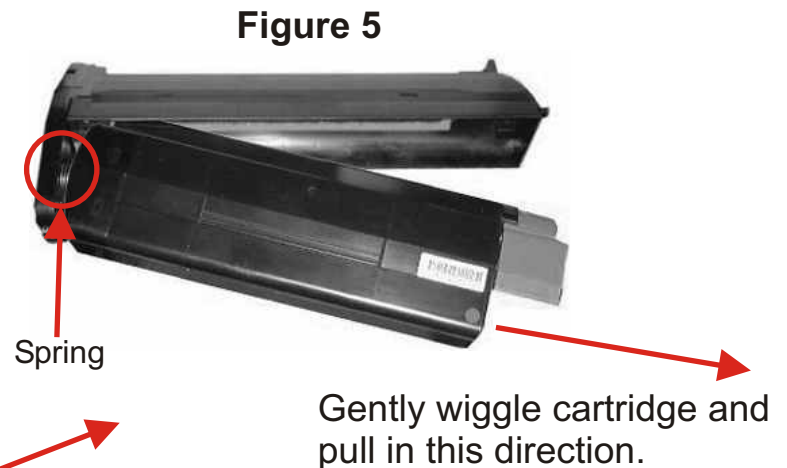

7. Holding the drum upside down start tapping on the side of the drum to dislodge the toner remaining in the drum.

Continue tapping until there is no more toner falling out.

Use a shop vacuum to remove the remaining toner.

Note: Do not use a standard household vacuum!

Reference Figure 6 on the right.

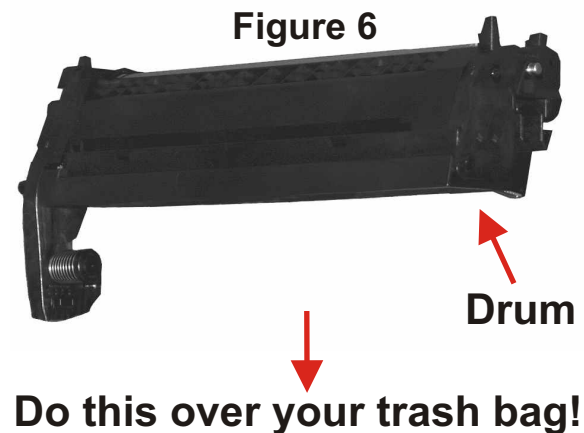

Figure 7

8. Remove the tape from your black sublimation cartridge.

Reference Figure 7 on the right.



Do this over your trash bag!

Figure 8

9. Place the sublimation cartridge back onto the drum assembly.

The cartridge fits back in the drum the same way it was removed in step 6. The spring end of the drum mates to the side of the cartridge opposite the blue knob.

Making sure the cartridge and drum assemblies are secure like when it was first removed from the printer then turn the blue knob and the cartridge will lock in place.

Reference Figure 8 on the right.



Re-attach

Blue Knob

Do this over your trash bag!

Figure 9

10. Remove the protective paper from the drum.

Reference Figure 9 on the right.



Protective paper

11. Place the cartridge back in the printer in the same location it was removed from.

Reference Figure 10 on the right. 



Figure 10

12. Repeat steps 3 through 11 for your other color cartridges.

13. Density setup in the OKI printer front panel.

After you have turned on your printer and allow the printer to finish its turn on cycle you need to set the toner density for the C, M, and Y cartridges.

The display indicator should be showing **ONLINE**. If there is no paper in tray 1 it will indicate that as well, however, you may continue.

Note: there is no setting for Black (K).

Reference Figure 11 on the right. 



Figure 11

14. Density settings.

Press the **PLUS (+)** key 4 times to display the **COLOR MENU**.

Press the **Enter** key to select the **COLOR MENU**. 

Reference Figure 12 on the right. 

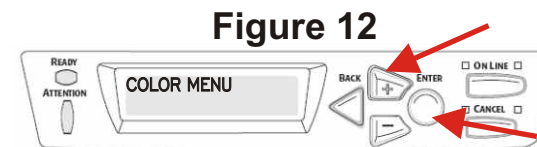



Figure 12

15. C,M,and Y settings. These will all be set at -2!

Press the **PLUS (+)** key 3 times and the display will indicate **C REG FINE AJST**. For **M** press 4 times, **Y** press 5 times.

Press the **ENTER KEY** then press the **MINUS (-)** key twice.

Press the **ENTER KEY** again. Press the **ONLINE** key to finalize the setting. 

Reference Figure 13 on the right. 

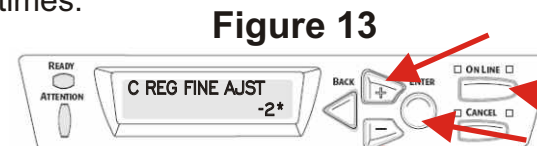

Figure 13

Repeat steps 14 and 15 for M and Y.

You are now ready to hook-up your printer to your PC per the instructions provided by OKIDATA.